



NC DEPARTMENT OF TRANSPORTATION  
 DIVISION OF HIGHWAYS  
 BRIDGE MANAGEMENT UNIT

ATTENTION

VERTICAL CLR. CHECKED

# BRIDGE INSPECTION REPORT

INSPECTION TYPE: Routine Inspection

COUNTY GASTON BRIDGE NUMBER 350142 INSPECTION CYCLE 2 YRS  
 ROUTE SR2213 ACROSS I85 M.P. 0

LOCATION 0.4 MI. E. JCT. SR2339

SUPERSTRUCTURE RC DECK ON PRECAST PRESTRESSED CONCRETE GIRDERS

SUBSTRUCTURE E.BTS:RC CAP ON STEEL PILES,INT.BNTS:RCP&B W/ SPREAD FTGS.

SPANS 1@59'7, 3@59'0

LONGITUDE 81° 5' 54.06" LATITUDE 35° 15' 39.63"

INSPECTION DATE 08/25/2014 PRESENT CONDITION FAIR

PRESENT POSTING Not Posted NOT POSTED PROPOSED POSTING \_\_\_\_\_

OTHER SIGNS PRESENT 4 DELINEATORS

Fracture Critical	<u>No</u>
Temporary Shoring	<u>No</u>
Scour Critical	<u>No</u>
Scour POA	<u>No</u>



SIGN NOTICE ISSUED FOR	NUMBERED REQUIRED
<u>No</u> WEIGHT LIMIT	_____
<u>No</u> DELINEATORS	_____
<u>No</u> NARROW BRIDGE	_____
<u>No</u> ONE LANE BRIDGE	_____
<u>No</u> LOW CLEARANCE	_____

WEST APPROACH

NATIONAL BRIDGE INVENTORY----- STRUCTURE INVENTORY AND APPRAISAL

Run Date: 10/07/2014

**IDENTIFICATION**

(1) STATE NAME -NORTH CAROLINA BRIDGE **350142**  
 (8) STRUCTURE NUMBER(FEDERAL) 00000000710142  
 (5) INVENTORY ROUTE (ON/UNDER) - ON 31022130  
 (2) STATE HIGHWAY DEPARTMENT DISTRICT 1  
 (3) COUNTY CODE 71 (4) PLACE CODE 39480  
 (6) FEATURE INTERSECTED - I85  
 (7) FACILITY CARRIED SR2213  
 (9) LOCATION 0.4 MI. E. JCT. SR2339  
 (11) MILEPOINT 0  
 (16) LAT 35° 15' 39.63" (17) LONG 81° 5' 54.06"  
 (98) BORDER BRIDGE STATE CODE PCT SHARE  
 (99) BORDER BRIDGE STRUCTURE NO

SUFFICIENCY RATING = 82  
 STATUS = Functionally Obsolete

**CLASSIFICATION CODE**

(112) NBIS BRIDGE SYSTEM - YES  
 (104) HIGHWAY SYSTEM Is not on NHS 0  
 (26) FUNCTIONAL CLASS - Minor Arterial 16  
 (100) STRAHNET HIGHWAY - Not a STRAHNET Route 0  
 (101) PARALLEL STRUCTURE - No Parallel Structure N  
 (102) DIRECTION OF TRAFFIC - 2-way Traffic 2  
 (103) TEMPORARY STRUCTURE -  
 (110) DESIGNATED NATIONAL NETWORK - Not on the National Network 0  
 (20) TOLL On Free Road 3  
 (31) MAINTAIN - State Highway Agency 01  
 (22) OWNER - State Highway Agency 01  
 (37) HISTORICAL SIGNIFICANCE - Not Eligible 5

**STRUCTURE TYPE AND MATERIAL**

(43) STRUCTURE TYPE MAIN: Prestressed Concrete  
 TYPE - Stringer Mutlibeam or Girder CODE 502  
 (44) STRUCTURE TYPE APPR :  
 TYPE - CODE 000  
 (45) NUMBER OF SPANS IN MAIN UNIT 4  
 (46) NUMBER OF APPROACH SPANS  
 (107) DECK STRUCTURE TYPE - 1 CODE  
 (108) WEARING SURFACE / PROTECTIVE SYSTEM :  
 (A) TYPE OF WEARING SURFACE - CODE  
 (B) TYPE OF MEMBRANE - CODE  
 (C) TYPE OF DECK PROTECTION - CODE

**CONDITION CODE**

(58) DECK 7  
 (59) SUPERSTRUCTURE 6  
 (60) SUBSTRUCTURE 5  
 (61) CHANNEL & CHANNEL PROTECTION N  
 (62) CULVERTS N

**LOAD RATING AND POSTING CODE**

(31) DESIGN LOAD HS 20 + MOD 6  
 (63) OPERATING RATING METHOD - Load Factor 1  
 (64) OPERATING RATING - HS-55 99  
 (65) INVENTORY RATING METHOD - Load Factor 1  
 (66) INVENTORY RATING - HS-34 61  
 (70) BRIDGE POSTING - No Posting Required 5  
 (41) STRUCTURE OPEN, POSTED ,OR CLOSED A  
 DESCRIPTION - Open, No Restriction

**AGE AND SERVICE**

(27) YEAR BUILT 1961  
 (106) YEAR RECONSTRUCTED  
 (42) TYPE OF SERVICE : ON - Highway  
 UNDER - Highway CODE 11  
 (28) LANES: ON STRUCTURE 2 UNDER STRUCTURE 6  
 (29) AVERAGE DAILY TRAFFIC 4500  
 (30) YEAR OF ADT 2012 (109) TRUCK ADT PCT 6%  
 (19) BYPASS OR DETOUR LENGTH 0 MI

**APPRAISAL CODE**

(67) STRUCTURAL EVALUATION 5  
 (68) DECK GEOMETRY 9  
 (69) UNDERCLEARANCES, VERTI & HORIZ 3  
 (71) WATERWAY ADEQUACY N  
 (72) APPROACH ROADWAY ALIGNMENT 8  
 (36) TRAFFIC SAFETY FEATURES 0000  
 (113) SCOUR CRITICAL BRIDGES N

**GEOMETRIC DATA**

(48) LENGTH OF MAXIMUM SPAN 58 FT  
 (49) STRUCTURE LENGTH 237 FT  
 (50) CURB OR SIDEWALK: LEFT 1.6 FT RIGHT 1.6 FT  
 (51) BRIDGE ROADWAY WIDTH CURB TO CURB 52.17 FT  
 (52) DECK WIDTH OUT TO OUT 55.5 FT  
 (32) APPROACH ROADWAY WIDTH (W/SHOULDERS) 52 FT  
 (33) BRIDGE MEDIAN - No Median CODE 0  
 (34) SKEW 31° (35) STRUCTURE FLARED 0  
 (10) INVENTORY ROUTE MIN VERT CLEAR 999.9 FT  
 (47) INVENTORY ROUTE TOTAL HORIZ CLEAR 52.17 FT  
 (53) MIN VERT CLEAR OVER BRIDGE RDWY 999.9 FT  
 (54) MIN VERT UNDERCLEAR REF Highway 18.17 FT  
 (55) MIN LAT UNDERCLEAR RT REF Highway 12.5 FT  
 (56) MIN LAT UNDERCLEAR LT REF - 3.67 FT

**PROPOSED IMPROVEMENTS**

(75) TYPE OF WORK - CODE  
 (76) LENGTH OF STRUCTURE IMPROVEMENT  
 (94) BRIDGE IMPROVEMENT COST  
 (95) ROADWAY IMPROVEMENT COST  
 (96) TOTAL PROJECT COST  
 (97) YEAR OF IMPROVEMENT COST ESTIMATE  
 (114) FUTURE ADT 9000 (115) YEAR FUTURE ADT 2025

**INSPECTIONS**

(90) INSPECTION DATE 08/25/2014  
 (92) CRITICAL FEATURE INSPECTION : (93) CFI DATE  
 A) FRACTURE CRIT DETAIL - NO A)  
 B) UNDERWATER INSP - NO B)  
 C) OTHER SPECIAL INSP NO C)  
 SCOUR

**NAVIGATION DATA**

(38) NAVIGATION CONTROL - Not Applicable CODE N  
 (111) PIER PROTECTION - CODE  
 (39) NAVIGATION VERTICAL CLEARANCE 0  
 (116) VERT - LIFT BRIDGE NAV MIN VERT CLEAR FT  
 (40) NAVIGATION HORIZONTAL CLEARANCE 0 FT

Structure No: 350142

County: GASTON

Run Date:

Span Number	Feature Intersected	Inventory Route	Minimum Maximum Vertical Clearance	Milepoint	Base Highway Network	LRS Inventory Route	Toll	Functional Classification	Numer of Lanes	Average Daily Traffic	Year of Average Daily Traffic	Total Horizontal Clearance	See Note 1							
													Reference Feature	Minimum Vertical Underclearance	Right Lateral Underclearance	Left Lateral Underclearance	Underclearance Appraisal Grade	STRAHNET Highway Designator	Direction of Traffic	Highway System of Route
	6	5	10	11	12	13	20	26	28	29	30	47	54A	54	55	56	69	100	102	104
2	I 85 S	11000850	18.33	22.80	1	10085		11	3	59500	2012	51.92	H	18.17	7.92	8	9	1	1	1
3	I 85 N	11000850	18.33	22.80	1	10085		11	3	59500	2012	52.17	H	18.17	12.5	3.67	9	1	1	1

Note 1: Items 54, 55, and 56 are not reported FHWA under route data points but are collected for each under route to determine the minimum value for Underclearance Appraisal Item 69. The under route that generates the lowest Underclearance Appraisal value will be reported on the Facility Carried record.

BRIDGE MANAGEMENT UNIT

DATA ON EXISTING STRUCTURE

Run Date: 10/07/2014

COUNTY : GASTON      DIVISION : 12      DISTRICT : 1      STRUCTURE NUMBER : 350142      LENGTH : 237 FEET

ROUTE CARRIED : SR2213      FEATURE INTERSECTED : I85

LOCATED : 0.4 MI. E. JCT. SR2339      BRIDGE NAME :      CITY : LOWELL

FUNC. CLASS : 16      SYST.ON : FA      SYST.UNDER : NFA      ADT & YR : 4500 2012      RAIL TYPE : LT 111 RT 111

BUILT : 1961      BY : SHC      PROJ : 8.16318      FED.AID PROJ : I-85-1(6)20      DESIGN LOAD : HS 20 + MOD

REHAB :      BY :      PROJ :      ALIGNMENT : TAN      SKEW : 121      LANES : ON 2 UNDER 6

NAVIGATION : VC 0 FT      HC 0 FT      HT. CRN. TO BED : 0 FT      WATER DEPTH : 0 FT

SUPERSTRUCTURE : RC DECK ON PRESTRESSED CONCRETE GIRDERS

SUBSTRUCTURE : E.BTS:RC CAPS/H- PILES; INT.BNTS:RC P&B/SPREAD FTGS.

SPANS : 1@59'-7, 3@59'

BEAMS OR GIRDERS : 9 LINES 45 PPC GIRDERS @ 6'-2 CENTERS

FLOOR : 6.25 RC/3.5 AWS      ENCROACHMENT : 12 PIPE, 9-4 TEL      DECK (OUT TO OUT) : 55.5 FT

CLEAR ROADWAY : 52.17 FT      BETWEEN RAILS : 55.33 FT      SIDEWALK OR CURB : LT 1.6 FT RT 1.6 FT

VERT.CL.OVER : 999.9 FT

INV.RTG. : HS-34      OPE.RTG. : HS-55      CONTR.MEMBER : intgd      POSTED : SV      TTST      DATE

SYSTEM : Primary S.R. Route      GREEN LINE ROUTE : N

UNDER ROUTES AND CLEARANCES

Span	Route Description	Vertical Clearances		Horizontal Clearances		
		MMVC	MVC	Total	Left	Right
2	I 85 S	18.33	18.17	51.92	8	7.92
3	I 85 N	18.33	18.17	52.17	3.67	12.50

Note: All measurements are in feet.

REMARKS :

# BRIDGE INSPECTION RECORD AND SUMMARY

INSPECTION TYPE Routine Inspection  
 BRIDGE NO. 350142 COUNTY GASTON ROUTE SR2213 OVER I85  
 STRUCTURE TYPE RC DECK ON PRECAST PRESTRESSED CONCRETE GIRDERS  
 ROUTE ORIENTATION W - E SPANS 1@59'7, 3@59'0

EVALUATION CODES: CRITICAL (C, 0 - 3); POOR (P, 4); FAIR (F, 5, 6); GOOD (G, 7 - 9)

INSPECTION ITEM				ITEM 61					
DECK ITEMS		GRADES							
1. WEARING SURFACE			F	45. CHANNEL & CHANNEL PROT.					
2. DECK NO. OF EA TYPE SPN GRADE RATES SI & A ITEM 58	a. CONCRETE	4	G				a. WATERWAY		
	b. TIMBER						b. ALIGNMENT		
	c. STEEL PLANK						c. SCOUR		
	d. OPEN GRID			d. SLOPE PROT., RIP-RAP, DIKES, ETC.					
3. RAILING			G	50. APPROACH ROADWAY CONDITION					
4. CURBS, WHEELGUARDS, PARAPETS, MEDIANS			G	51. APPROACH SLABS					
5. WALKWAYS (ON OR ATTACHED TO STRUCTURE)				52. PAINT SYSTEM CODE					
6. DECK EXP JTS. OR DEVICES. NO. OF EACH	a. STEEL PL OR FINGER			53. UTILITIES					
	b. MISC PREFAB			54. RESPONSE TO LIVE LOAD					
	c. COMPRESSION SEAL			55. ESTIMATED REMAINING LIFE					
	d. STANDARD JOINTS	3	G	60. REGULATORY SIGN NOTICE ISSUED					
	e. OPEN JOINTS			61. PROMPT-ACTION NOTICE ISSUED					
7. DECK DEBRIS (INCLUDES EXCESS SAND/GRAVEL)			G	62. PRESENTLY POSTED					
SUPER STR. (FM. 1 (90)B TRUSS) ITEM 59				70. SI&A GENERAL CONDITION RATINGS					
10. LONGITUDINAL BEAMS OR GIRDERS			F	a. DECK		ITEM 58			
11. LONGITUDINAL JOIST OR STRINGERS				b. SUPERSTRUCTURE		ITEM 59			
12. INT. DIAP'S, X-FRAMES, BRACING & CONN'S			G	c. SUBSTRUCTURE		ITEM 60			
13. END DIAP'S, CURTAIN WALLS, & CONN'S			G	d. CHANNEL & CHANNEL PROT.		ITEM 61			
14. FLOOR BEAMS AND CONNECTIONS				71. SI&A FIELD APPRAISAL RATINGS					
15. BEARING ASSEMBLIES (INCLUDING MISALIGN)			G	a. WATERWAY ADAQUACY					
16. DRAINAGE SYSTEM (ON STRUCTURE)			G	b. APPR. RDWY. ALIGNMENT					
17. MOVABLE SPAN MACHINERY				72. FIELD SCOUR EVALUATION					
SUB STR. ITEMS. ITEM 60 (INCLUDE SCOUR)				USE OF INSP. ACCESSIBILITY EQUIPMENT					
35. TIM SUB STR.	a. ABUT. & INT. BENT CAPS & RISERS			SNOOPER (CODE S, 4, OR N)					
	b. PILES, POST, SILLS, & BRACING					HRS			
	c. BULKHEADS, WING'S, & TIE BACKS			LADDER		NO			
36. CONC SUB STR.	a. ABUT. & INT. BENT CAPS		F	BUCKET TRUCK					
	b. ABUT. & BENT COL'S BREASTWALLS		F	BOAT					
	c. ABUT. & INT. BENT PILES			OTHER					
	d. BACKWALLS, WING'S, RETAIN. WALLS		G						
	e. ABUT. & BENT FOOTINGS & SILLS								
37. STEEL SUB STR.	a. ABUT. & INT. BENT CAPS & RISERS			SPECIAL INSPECTION REQUESTED FOR					
	b. PILES, BRACING, AND BULKHEADS								
38. FOUNDATION PILES TYPE MATERIAL				NOTE					
39. SLOPE PROT., RIP-RAP (INCLUDE DRAINAGE)			F						
40. FENDER SYSTEMS				80. INSPECTED BY: <i>JH RL</i>					
41. DRIFT				81. REVIEWED BY:					

Bridge I&A Form 1(82)H		<b>FIELD INSPECTION REPORT</b> <u>Bridge Inspection &amp; Analysis</u>	
State of North Carolina Dept. of Transportation Division of Highways			
Team Leader <b>derek rickus</b>			
Assisted By <b>eap</b>			
Item No.	Grade		
1	F	TRANS. CRACKING CRACKING IN THE ASPHALT WEARING SURFACE IN SPAN 1. SIMILAR IN SPAN 2 AND 3.	
2a	G	THE DECK IS NOT VISIBLE FROM THE TOPSIDE DUE TO ASPHALT OVERLAY. THE UNDERSIDE SHOWS HAIRLINE CRACKING WITH EFFLORESCENCE IN THE OVERHANGS.	
10	F	SPALL ON THE EXTERIOR GIRDERS AT THE INT. BENTS WITH STEEL EXPOSED FOR 3" L X 2" HIGH.	
10A	NO	no curved girders	
36a	F	3' WIDE X 1' LONG SPALL BTWN. COLUMNS 1 AND 2 WITH REBAR EXPOSED AT BENT 3. SPALL 3' L X 2' WIDE X 1" DEEP WITH REBAR EXPOSED ALONG THE BOTTOM OF BENT 3 CAP IN BTWN. BAYS 1 AND 3. SPALL FORMING BTWN. COLUMNS 2 AND 3 AT BENT 3 2' W X 18" LONG. SPALL FORMING ALONG THE TOP CORNER OF BENT 1 CAP WEST FACE 10" HIGH X 32" WIDE, BTWN. BEAM. 8 AND 9.	
36b	F	BENT 3, COLUMN 3 SOUTH FACE HAS A 2 FT DIAMETER SPALL FORMING. COLUMNS HAVE RANDOM HAIRLINE VERTICAL CRACKS THROUGHOUT.	
36e		not visible	
38		not visible	
39	F	CONCRETE SLOPE PROT. CRACKED AT THE TOP FOR 15' HORIZONTALLY.	

# BRIDGE INSPECTOR'S RECOMMENDATION FOR MAINTENANCE REPAIRS

Bridge: 350142

County GASTON

Date: 08/25/2014

## These Repairs Should Be Made Within Twelve Months From Date Of This Inspection

MMS Code	Description of Function	Unit	Quantity	Remarks	Est. Cost
3306	Maintain Concrete Superstructure Components	SF	6	SPALL ON THE EXTERIOR GIRDERS AT THE INT. BENTS WITH STEEL EXPOSED FOR 3" L X 2" HIGH.	
3334	Bridge Bearings	EA	4	THE EXTERIOR BRGS AT THE ABUTS. SHOW SURFACE RUST WITH 1/16" DEEP PITTING.	
3348	Maintain Concrete Substructure Components	LF	2	SPALL FORMING BTWN. COLUMNS 2 AND 3 AT BENT 3 2' W X 18" LONG.	
3348	Maintain Concrete Substructure Components	LF	3	3' WIDE X 1' LONG SPALL BTWN. COLUMNS 1 AND 2 WITH REBAR EXPOSED AT BENT 3.	
3348	Maintain Concrete Substructure Components	LF	3	SPALL 3' L X 2' WIDE X 1" DEEP WITH REBAR EXPOSED ALONG THE BOTTOM OF BENT 3 CAP IN BTWN. BAYS 1 AND 3.	
3348	Maintain Concrete Substructure Components	LF	3	SPALL FORMING ALONG THE TOP CORNER OF BENT 1 CAP WEST FACE 10" HIGH X 32" WIDE, BTWN. BEAM. 8 AND 9.	
3352	Maint Slope Protection	SF	15	CONCRETE SLOPE PROT. CRACKED AT THE TOP FOR 15' HORIZONTALLY.	

Key

 Priority Maintenance Item

 Critical Finding Item

 Priority Maintenance Level Not Determined



TRANS. CRACKING CRACKING IN THE ASPHALT WEARING SURFACE IN SPAN 1. SIMILAR IN SPAN 2 AND 3.



THE EXTERIOR BRGS AT THE ABUTS. SHOW SURFACE RUST WITH 1/16" DEEP PITTING.





CONCRETE SLOPE PROT. CRACKED AT THE TOP FOR 15' HORIZONTALLY.



3' WIDE X 1' LONG SPALL BTWN. COLUMNS 1 AND 2 WITH REBAR EXPOSED AT BENT 3.



BENT 2



SPALL ON THE EXTERIOR GIRDERS AT THE INT. BENTS WITH STEEL EXPOSED FOR 3" L X 2" HIGH.



SPALL 3' L X 2' WIDE X 1" DEEP WITH REBAR EXPOSED ALONG THE BOTTOM OF BENT 1 CAP IN BTWN. BAYS 1 AND 3.



SPALL FORMING BTWN. COLUMNS 2 AND 3 AT BENT 1-2' W X 18" LONG.



SPALL FORMING ALONG THE TOP CORNER OF BENT 1 CAP WEST FACE 10" HIGH X 32" WIDE, BTWN. BEAM. 8 AND 9.

# Structure Data Worksheet

Spans

County: GASTON      Structure No: 350142      Date: 08/25/2014      Inspected By: dcr

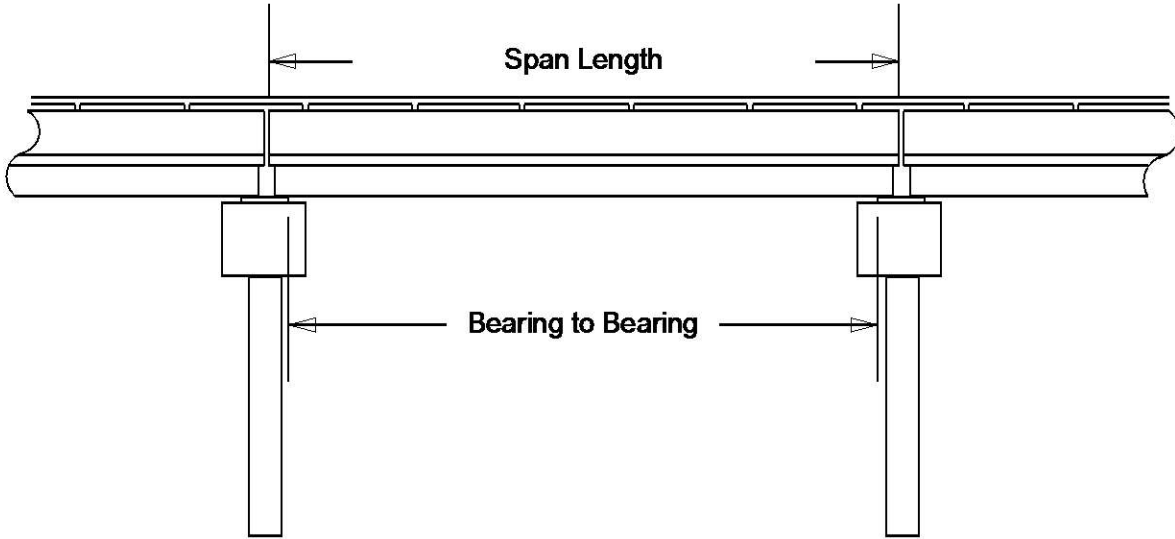

Span No	Span Length	Bearing to Bearing	Comments
1	59.583'	57.500'	
2	59.000'	57.542'	
3	59.000'	57.542'	
4	59.000'	57.208'	NBIS =231.583'

# Bridge Inspection Field Sketch



Roadway	48.00ft Wide	2 Paved Lanes	Looking East
Left Shoulder	2ft Wide	2.00ft Paved	
Right Shoulder	2ft Wide	2.00ft Paved	
Left Guardrail			
Right Guardrail			

VERIFIED BY DEREK RICKUS ON 8/21/2014

**Title**

APPROACH ROADWAY

**Description**

LOOKING EAST

Bridge No: 350142

Drawn By: DJA

Date: 8/20/2008

File Name: S0298000774

# Bridge Inspection Field Sketch

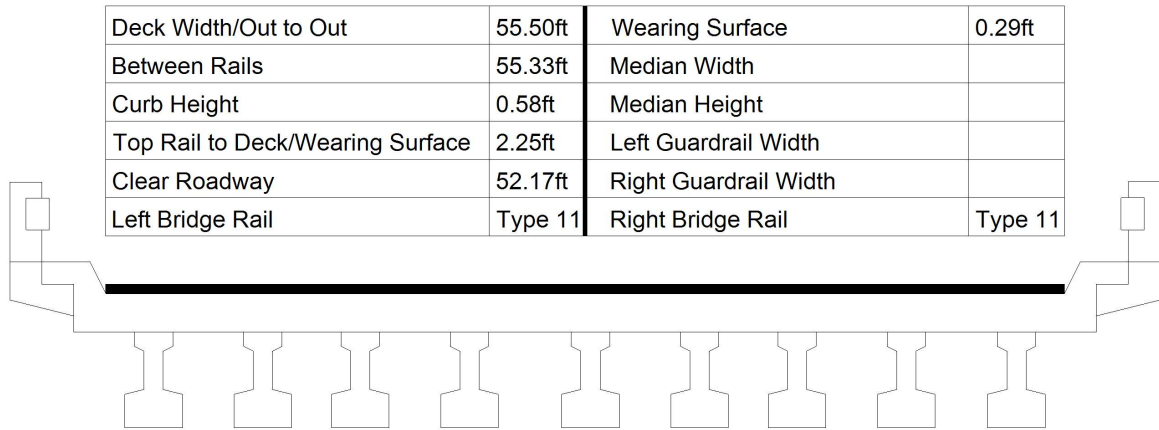

Measurements for Span #	1	SPANS 2 TO 4 SIMILAR	
Deck Thickness	0.52	Left Overhang	3.13
Top of Rail to Bottom of Beam		Right Overhang	3.13

Beam No	Beam Type	Spacing	Comments
1	PPC Girder	6.17ft	
2	PPC Girder	6.17ft	
3	PPC Girder	6.17ft	
4	PPC Girder	6.17ft	
5	PPC Girder	6.17ft	
6	PPC Girder	6.17ft	
7	PPC Girder	6.17ft	
8	PPC Girder	6.17ft	
9	PPC Girder		

NOTE: 9 LINES OF 4" DIAM. PVC IN BAY 2

NOTE: 12" DIAM. C.I. PIPE IN BAY 1

### BEAMS

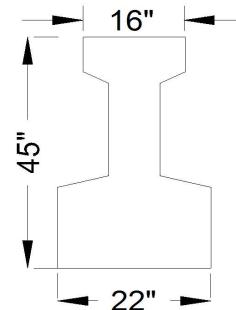

VERIFIED BY DEREK RICKUS ON 8/21/2014

<b>Title</b> DECK DIMENSIONS		<b>Description</b> TYPICAL SECTION	
<b>Bridge No:</b> 350142	<b>Drawn By:</b> DJA	<b>Date:</b> 8/20/2008	<b>File Name:</b> S0298000775

# Bridge Inspection Field Sketch

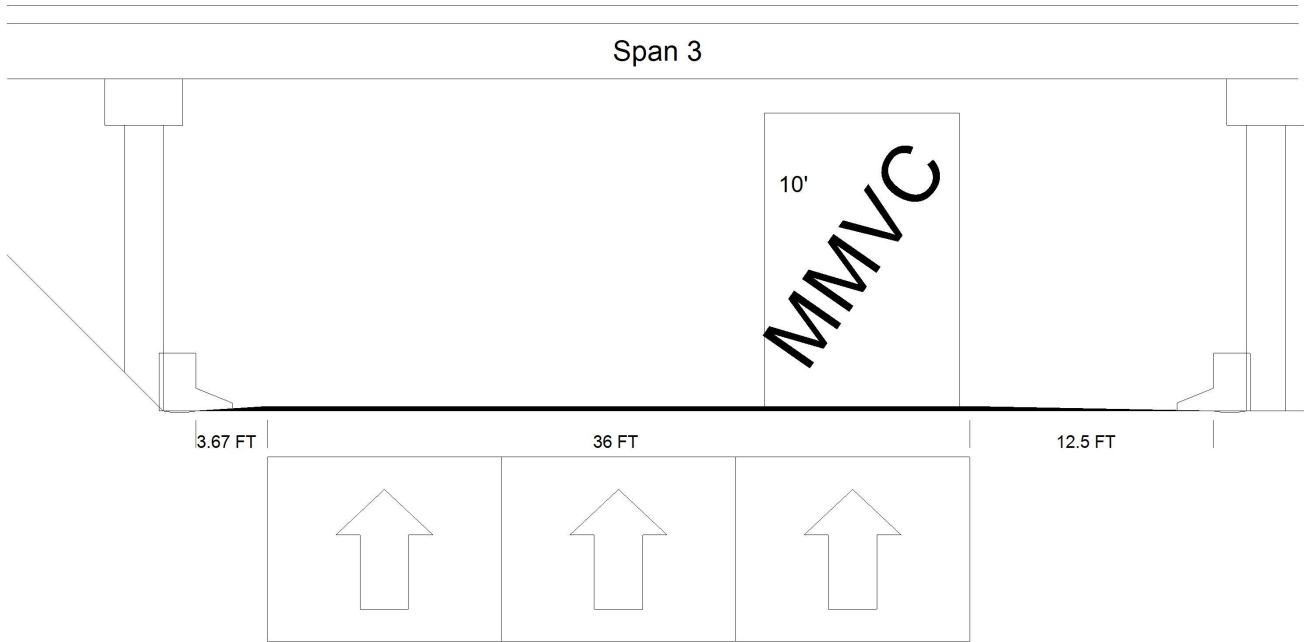

Roadway 1		Direction of Traffic	North
Distance to Left Rail	3.67FT	Distance to Right Rail	12.5FT
Distance to Left Toe of Slope		Distance to Left Bent	5.33FT
Distance to Right Toe of Slope		Distance to Right Bent	14.17FT
MMVC	18.33 Ft at Beam 1, 10 FT from RIGHT EDGE OF PAVEMENT		
MVC	18.17 Ft at Beam 1, 24 FT from RIGHT EDGE OF PAVEMENT		

VERIFIED BY DEREK RICKUS ON 8/21/2014

**Title**

NORTHBOUND UNDERCLEARANCE

**Description**

NORTHBOUND UNDERCLEARANCE

Bridge No: 350142

Drawn By: DJA

Date: 8/21/2008

File Name: S0298000776



# Bridge Inspection Field Sketch

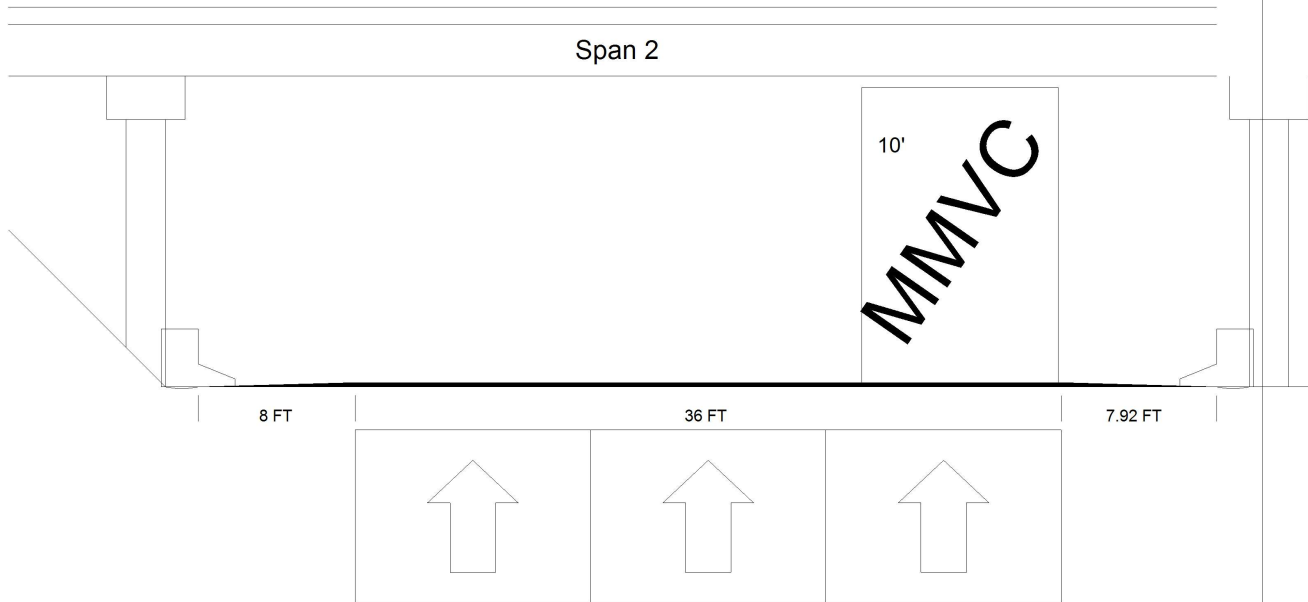

Roadway 1		Direction of Traffic	South
Distance to Left Rail	8FT	Distance to Right Rail	7.92FT
Distance to Left Toe of Slope		Distance to Left Bent	9.67FT
Distance to Right Toe of Slope		Distance to Right Bent	9.58FT
MMVC	18.33 Ft at Beam 1, 10 FT from RIGHT EDGE OF PAVEMENT		
MVC	18.17 Ft at Beam 1, 26 FT from RIGHT EDGE OF PAVEMENT		

VERIFIED BY DEREK RICKUS ON 8/21/2014

<b>Title</b>		<b>Description</b>	
SOUTHBOUND UNDERCLEARANCE		SOUTHBOUND UNDERCLEARANCE	
Bridge No: 350142	Drawn By: DJA	Date: 8/21/2008	File Name: S0298000777

# Bridge Inspection Field Sketch

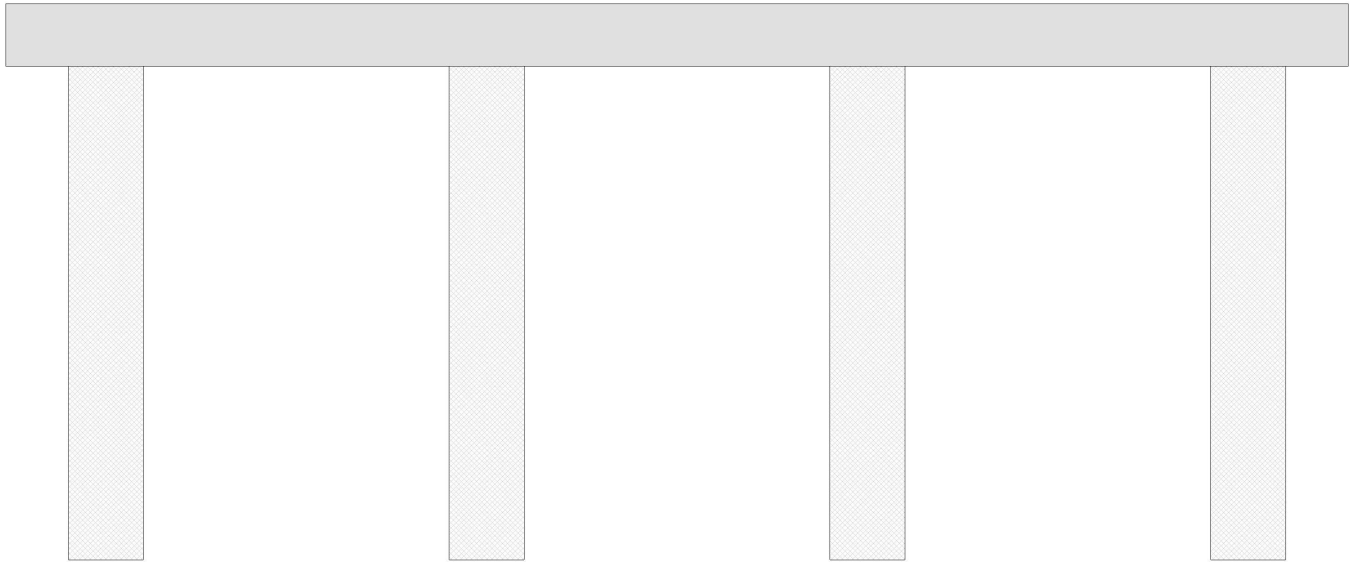

<b>Cap Information</b>			<b>Material</b> Cast-in-Place Concrete							
Length	Width	Height	Left Overhang	Right Overhang	Left Beam to End of Cap.	Right Beam to End of Cap.				
53.750 ft.	3.000 ft.	2.500 ft.	4.000 ft.	4.000 ft.	1.833 ft.	1.833 ft.				
<b>Subcap Information</b>			<b>Material</b>							
Length	Width	Height	Left Overhang	Right Overhang	Left Pile to Splice.					
<b>Sill Information</b>			<b>Material</b>							
Length	Width	Height								
Pile #	Material	Spacing	Width/Dia.	Height	Length	Orientation	Driven?	Replacement?	Removed?	Collar?
1	Concrete	15.25 ft.	2.5 ft.	3.0 ft.		Vertical	No	No	No	No
2	Concrete	15.25 ft.	2.5 ft.	3.0 ft.		Vertical	No	No	No	No
3	Concrete	15.25 ft.	2.5 ft.	3.0 ft.		Vertical	No	No	No	No
4	Concrete		2.5 ft.	3.0 ft.		Vertical	No	No	No	No
<p><b>VERIFIED BY DEREK RICKUS ON 8/21/2014</b></p>										
<b>Bent/Abutment #:</b> 1			<b>Similar Bents:</b> 2 AND 3							

<b>Title</b>			<b>Description</b>			
SUBSTRUCTURE			DETAILS			
<b>Bridge No:</b> 350142	<b>Drawn By:</b> DEREK RICKUS		<b>Date:</b> 8/15/2012		<b>File Name:</b> S0142001850	



WEST APPROACH



INFOR. AT THE SOUTHWEST CORNER



INFOR. PLATE AT THE NORTHEAST CORNER



EAST APPROACH



ABUT. 2



UTILITY IN BAY 8



UTILITY IN BAY 7



BENT 3



LOOKING SOUTH



BENT 3



ABUT. 2